

NITROGAS

DIE STORAGE GAS SPRING



NITROGAS is a global company that has a worldwide presence through its own network of subsidiaries and extensive distributor network.

SUBSIDIARIES

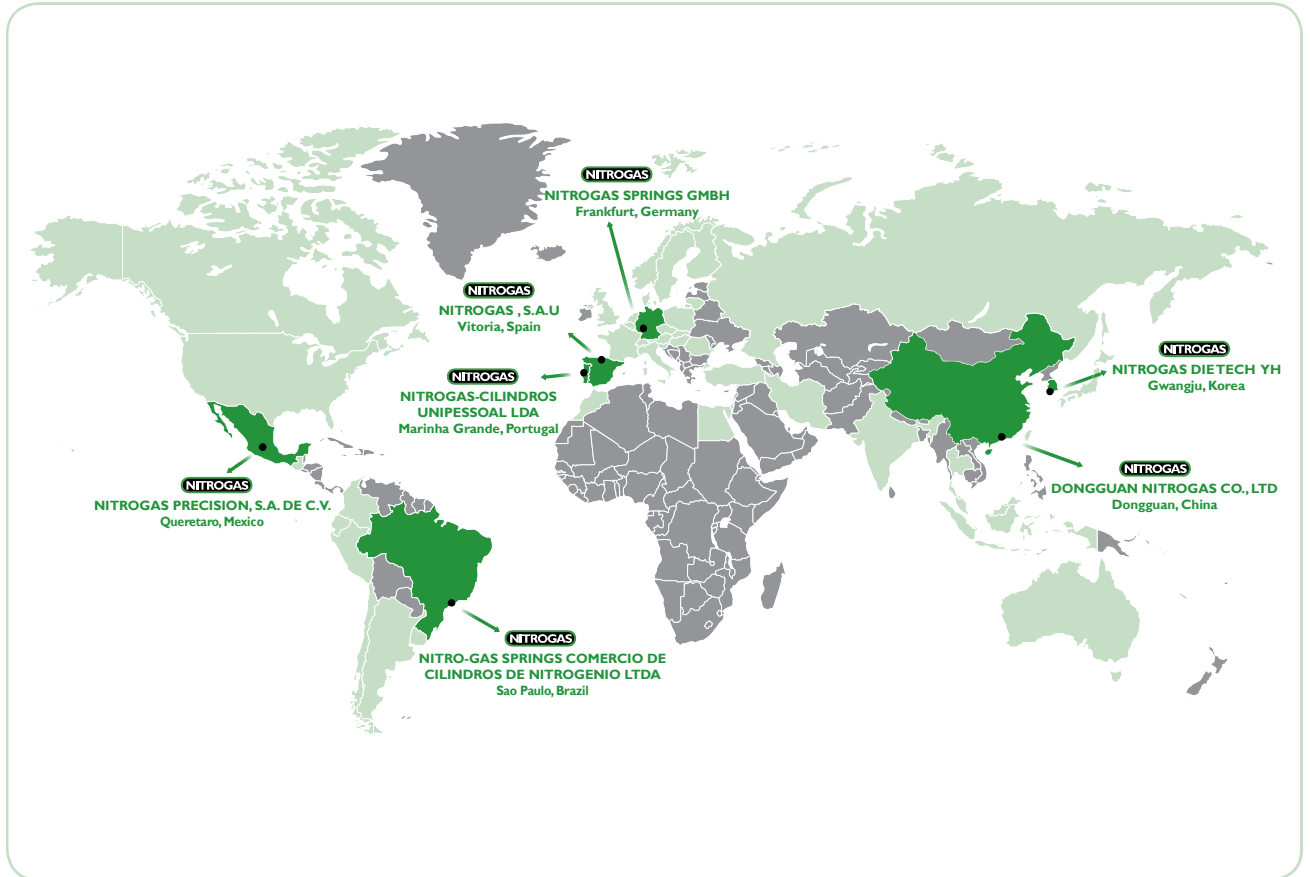

DISTRIBUTORS

WESTERN EUROPE

Austria	Italy	Sweden
Denmark	Netherlands	Switzerland
Finland	Norway	United Kingdom
France	Portugal	
Germany	Spain	

EASTERN EUROPE

Slovakia	Hungary
Slovenia	Czech Republic
Lithuania	Poland
Romania	Turkey
Russia	

AMERICA

Argentina	Guatemala
Brazil	Mexico
Canada	Peru
Chile	Uruguay
Colombia	USA
Ecuador	

ASIA-OCEANIA

Australia	Japan
China	Korea
India	Malaysia
Indonesia	Russia
Iran	Taiwan
Israel	Thailand

AFRICA

Morocco
South Africa

Our customers can learn more about the nearest contact on our website:

www.nitrogas.com/es/Worldwide.aspx

DIE STORAGE CYLINDERS

Basic Information	2
SG-1500	4
SG-3000	6
SG-5000	8
SG-7500	10



DIE STORAGE CYLINDERS

NITROGAS Die Storage Cylinders are desined to substitute conventional distance blocks.

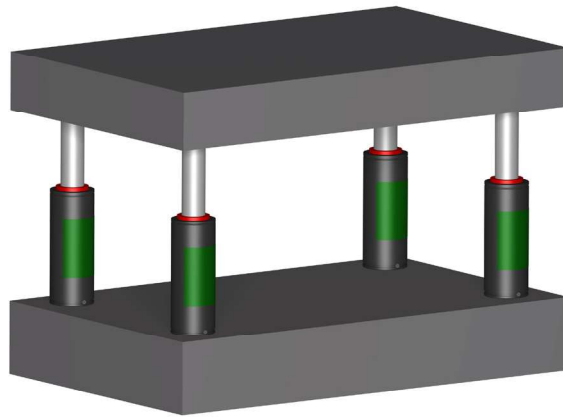

Features and benefit of NITROGAS Die Storage Cylinders:

- Capability of storage tools of diferent sizes (from 12 to 40 tons).
- Double life than standard gas springs.
- ISO gas springs dimension.
- Initial forces from 1.500daN to 7.500daN.
- Stroke lenghts of 25 up to 300mm.
- Standard mounting possibilities.
- Permanent lubrication.
- All Storage Cylinders included ESK system, which accept two degree of side load.
- Total Security: Over-Stroke. Over-Pressure and Excessive Return Speed Protection system.

	Initial Force(daN) at 150bar / 20°C	25	38	50	63.5	80	100	125	160	200	250	300
SG-1500	1500	*	*	*	*	*	*	*	*	*	*	*
SG-3000	3000	*	*	*	*	*	*	*	*	*	*	*
SG-5000	5000	*	*	*	*	*	*	*	*	*	*	*
SG-7500	7500	*	*	*	*	*	*	*	*	*	*	*

Basic Information

- Pressure medium Nitrogen
- Max. charging pressure 150 bar (at 20°C)
- Min. charging pressure 20 bar (at 20°C)
- Min. compression <1,6
- Operating temperature 0-80°C
- Force increase by temperature ±0,34% / °C
- Max. piston rod velocity 2m/s

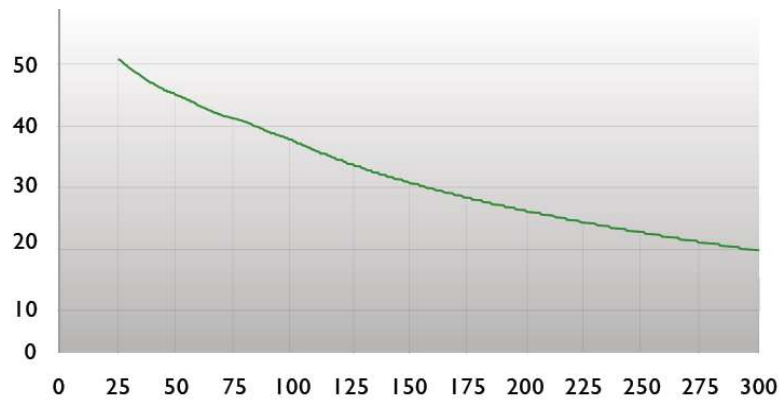



CNOMO
EM24.54.700

PSA
E24.54.815.G

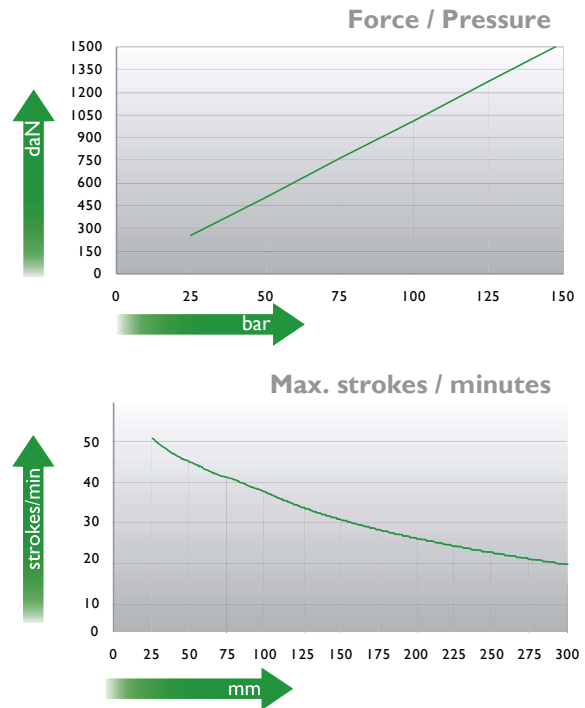
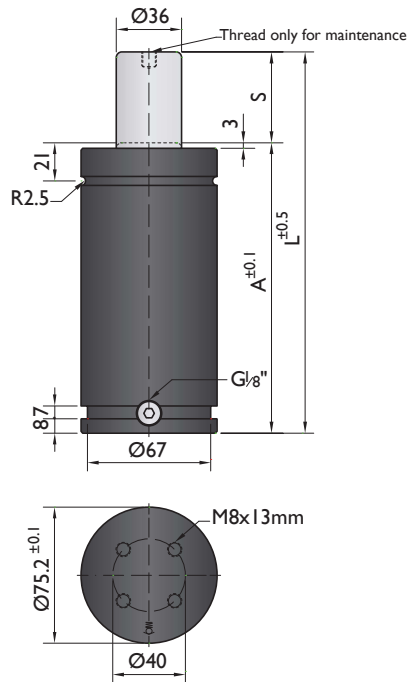

Ordering example: 4 x SG-1500-125

Order No.	S ⁽¹⁾ mm	L mm	A mm	F ₀ ⁽²⁾ daN (20°C, 150 bar)	F daN	(3)	kg
SG-1500-25	25	160	135	1500	1800	No	3.48
SG-1500-38	38.1	186.2	148.1		1900	No	3.71
SG-1500-50	50	210	160		2000	No	4.05
SG-1500-63	63.5	237	173.5		2000	No	4.28
SG-1500-80	80	270	190		2000	No	4.37
SG-1500-100	100	310	210		2000	Yes	4.44
SG-1500-125	125	360	235		2100	Yes	4.87
SG-1500-160	160	430	270		2100	Yes	5.29
SG-1500-200	200	510	310		2100	Yes	6.75
SG-1500-250	250	610	360		2100	Yes	7.62
SG-1500-300	300	710	410	2100	Yes	8.48	

⁽¹⁾ other strokes under request

⁽²⁾ alternative forces upon request

⁽³⁾ ESK available for other strokes

* other strokes under request

* alternative forces upon request



Pressure medium N₂
Max. Charging pressure 150 bar
Min. Charging pressure 25 bar

Working temperature 0-80°C
Temperature related force increase +0.34%/°C
Max. working speed 2 m/s

Min. security stroke 10%
Repair Kit KIT G-1500
Linkable M6-G1/8"

Mounting possibilities

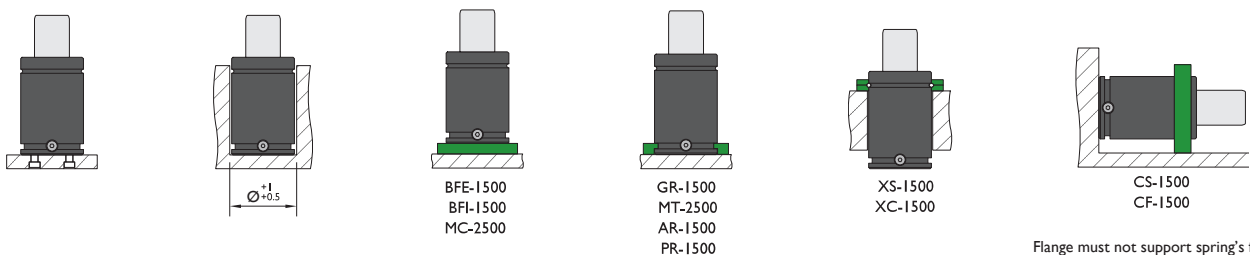

Flanges

BFE-1500

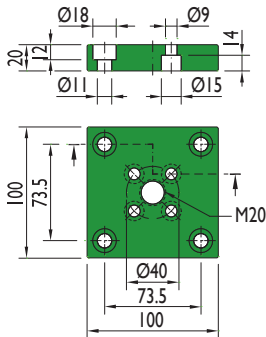

BFI-1500

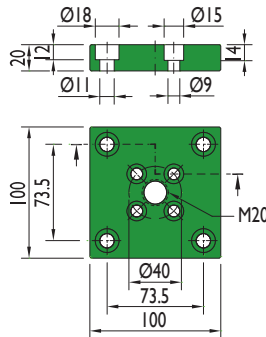

MC-2500

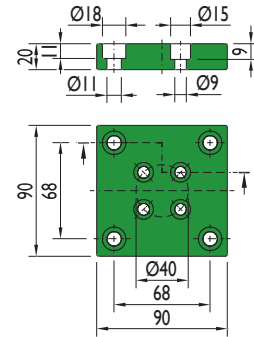

GR-1500

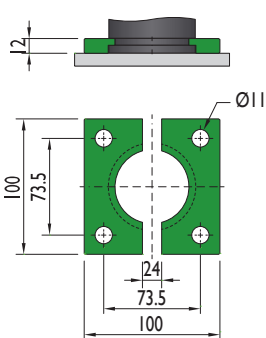

MT-2500

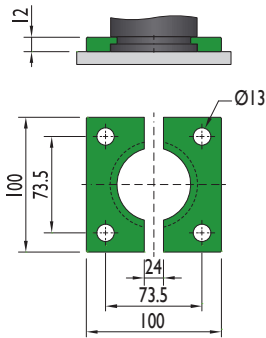

AR-1500

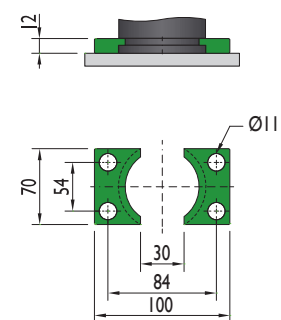

XS-1500

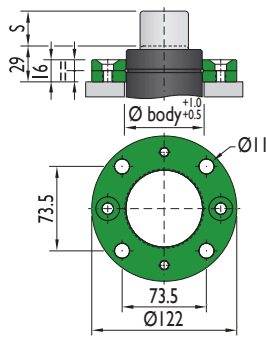

XC-1500

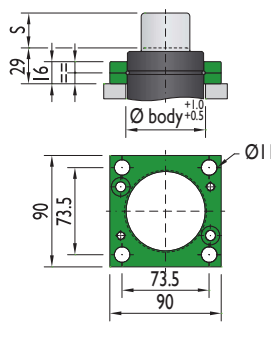

PR-1500

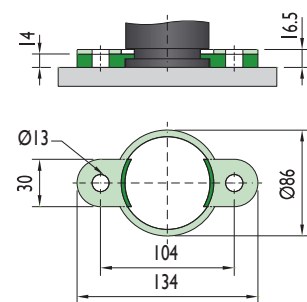

CS-1500

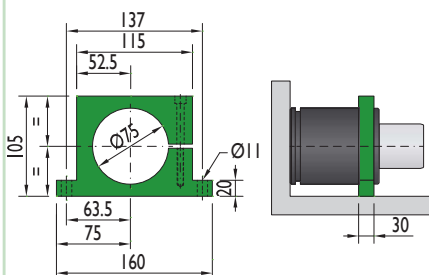

Flange must not support spring's force



CF-1500

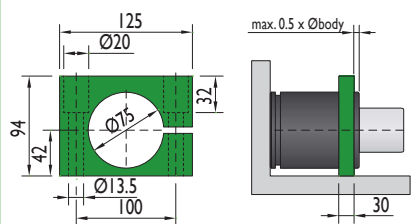

Flange must not support spring's force



Special mounts available on
www.nitrogas.com



CNOMO
EM24.54.700

PSA
E24.54.815.G

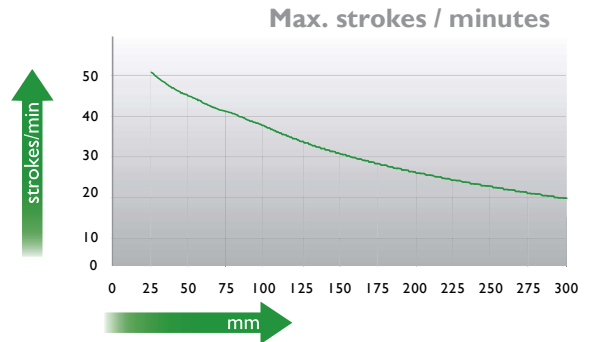
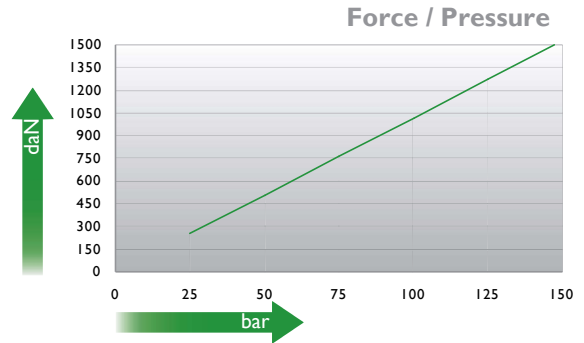
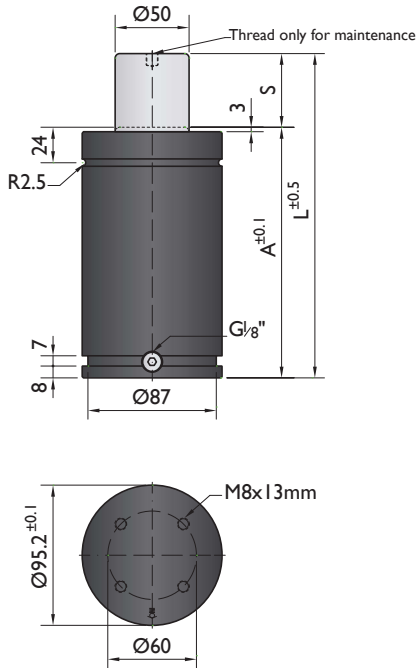

Ordering example: 4 x SG-3000-125

Order No.	S ⁽¹⁾ mm	L mm	A mm	F ₀ ⁽²⁾ daN	F daN	ESK ⁽³⁾	kg
SG-3000-25	25	170	145		3500	No	5.86
SG-3000-38	38.1	196.2	158.1		3700	No	6.20
SG-3000-50	50	220	170		3800	No	6.66
SG-3000-63	63.5	247	183.5		3900	No	7.00
SG-3000-80	80	280	200		4000	No	8.28
SG-3000-100	100	320	220	3000	4200	Yes	8.65
SG-3000-125	125	370	245		4200	Yes	8.97
SG-3000-160	160	440	280		4200	Yes	9.86
SG-3000-200	200	520	320		4300	Yes	10.92
SG-3000-250	250	620	370		4300	Yes	12.25
SG-3000-300	300	720	420		4400	Yes	13.58

⁽¹⁾ other strokes under request

⁽²⁾ alternative forces upon request

⁽³⁾ ESK available for other strokes

* other strokes under request

* alternative forces upon request



Pressure medium N₂
Max. Charging pressure 150 bar
Min. Charging pressure 25 bar

Working temperature 0-80°C
Temperature related force increase +0.34%/°C
Max. working speed 2 m/s

Min. security stroke 10%
Repair Kit KIT G-3000
Linkable M6-G1/8"

Mounting possibilities

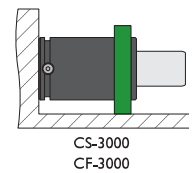
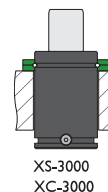
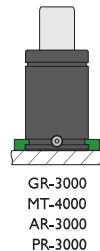
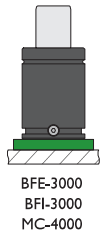
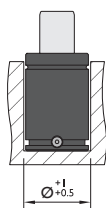
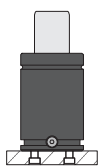

Flange must not support spring's force

Flanges

BFE-3000

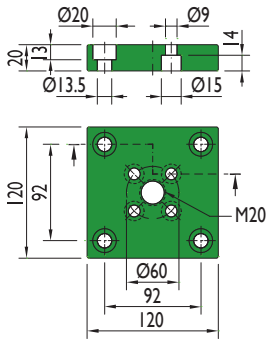

BFI-3000

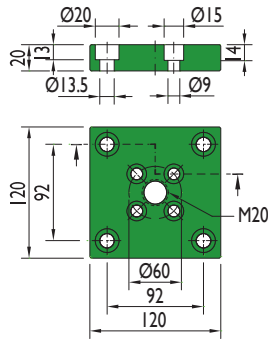

MC-4000

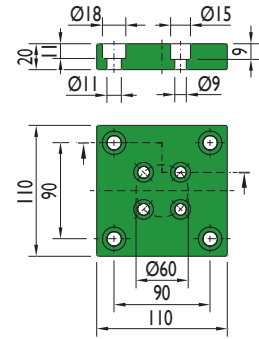

GR-3000

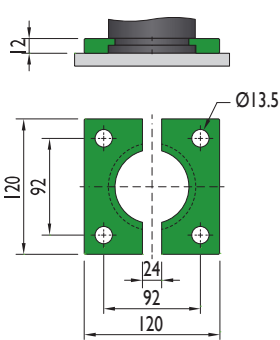

MT-4000

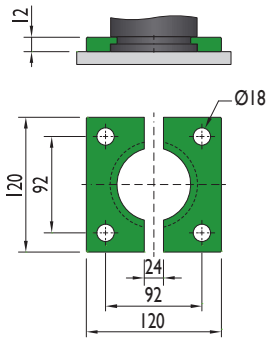

AR-3000

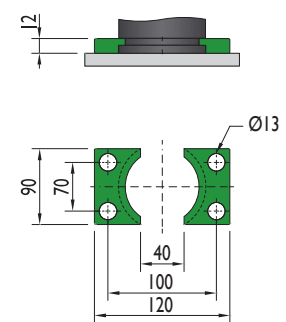

XS-3000

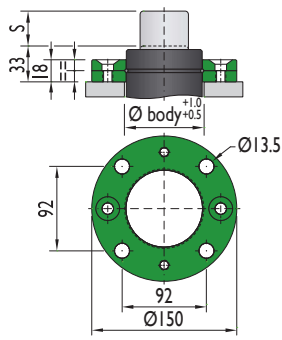

XC-3000

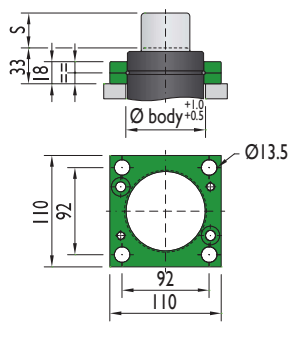

PR-3000

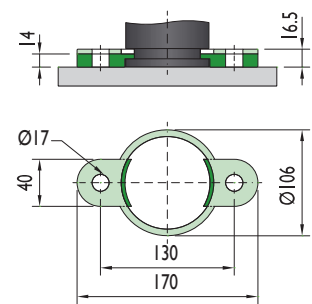

CS-3000

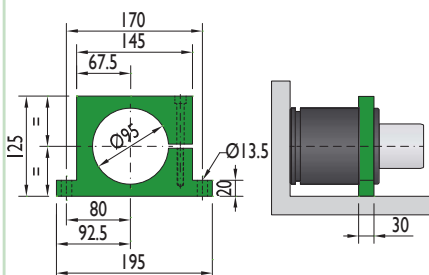

Flange must not support spring's force



CF-3000

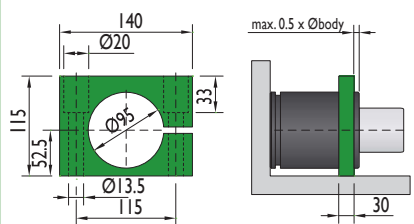

Flange must not support spring's force



Special mounts available on
www.nitrogas.com



CNOMO
EM24.54.700

PSA
E24.54.815.G

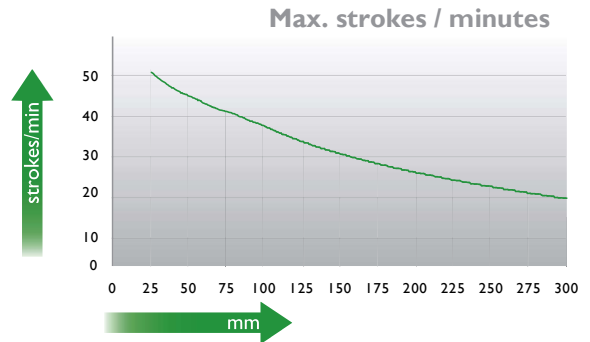
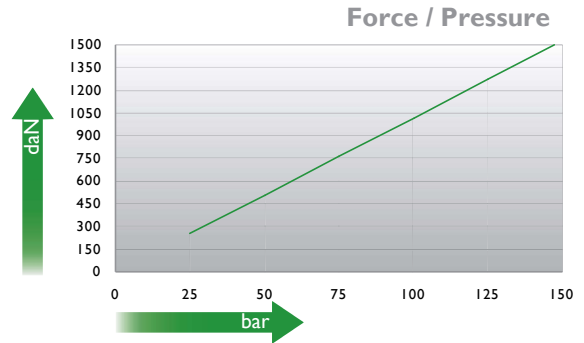
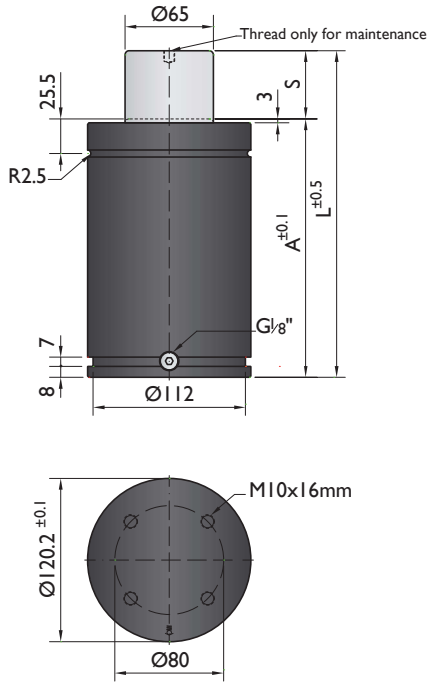

Ordering example: 4 x SG-5000-125

Order No.	S ⁽¹⁾ mm	L mm	A mm	F ₀ ⁽²⁾ daN (20°C, 150 bar)	F daN	 ⁽³⁾	kg
SG-5000-25	25	190	165	5000	5900	No	10.76
SG-5000-38	38.1	216.2	178.1		6200	No	11.33
SG-5000-50	50	240	190		6400	No	11.80
SG-5000-63	63.5	267	203.5		6600	No	12.26
SG-5000-80	80	300	220		6700	No	13.21
SG-5000-100	100	340	240		7200	Yes	14.86
SG-5000-125	125	390	265		7300	Yes	16.25
SG-5000-160	160	460	300		7400	Yes	17.54
SG-5000-200	200	540	340		7500	Yes	21.16
SG-5000-250	250	640	390		7500	Yes	22.61
SG-5000-300	300	740	440	7600	Yes	26.51	

⁽¹⁾ other strokes under request

⁽²⁾ alternative forces upon request

⁽³⁾ ESK available for other strokes

* other strokes under request

* alternative forces upon request



Pressure medium N₂
Max. Charging pressure 150 bar
Min. Charging pressure 25 bar

Working temperature 0-80°C
Temperature related force increase +0.34%/°C
Max. working speed 2 m/s

Min. security stroke 10%
Repair Kit KIT G-5000
Linkable M6-G1/8"

Mounting possibilities

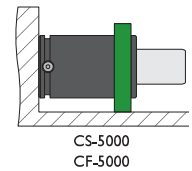
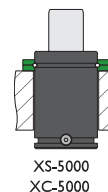
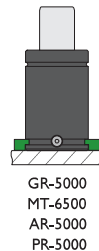
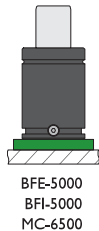
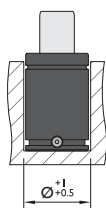
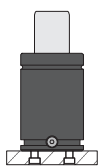

Flange must not support spring's force

Flanges

BFE-5000

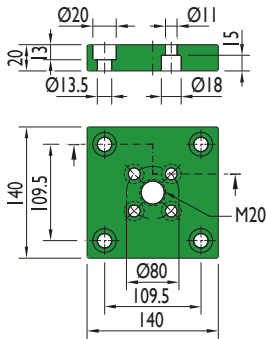

BFI-5000

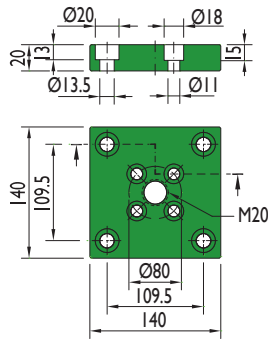

MC-6500

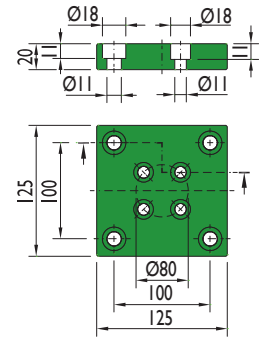

GR-5000

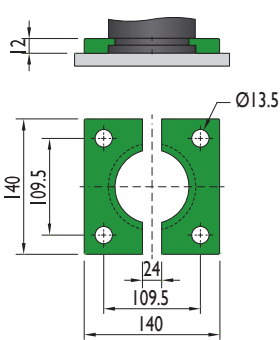

MT-6500

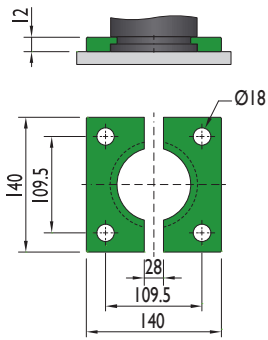

AR-5000

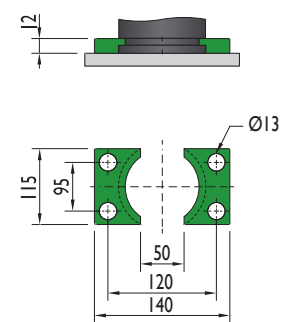

XS-5000

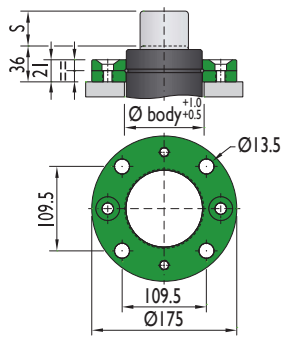

XC-5000

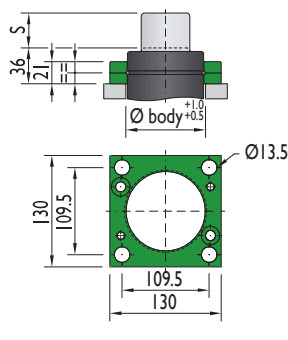

PR-5000

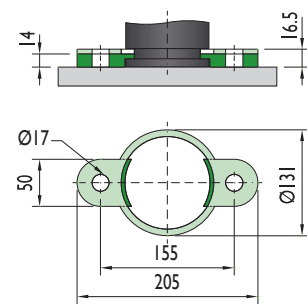

CS-5000

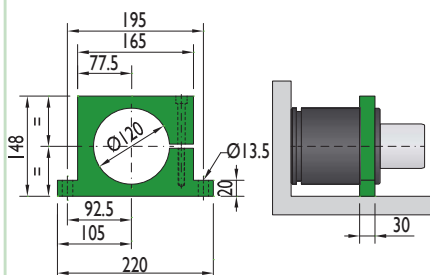

Flange must not support spring's force



CF-5000

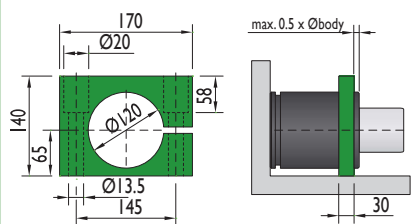

Flange must not support spring's force



Special mounts available on
www.nitrogas.com



CNOMO
EM24.54.700

PSA
E24.54.815.G

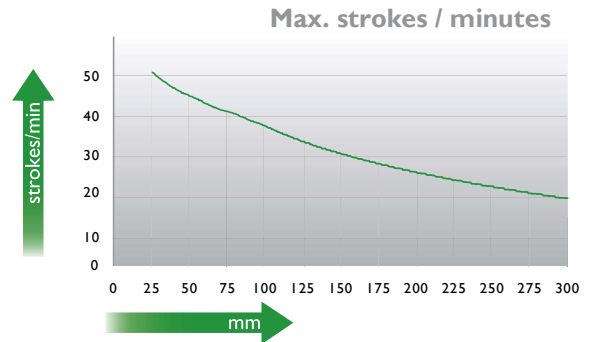
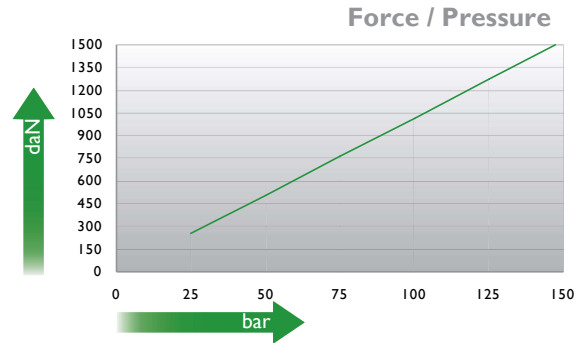
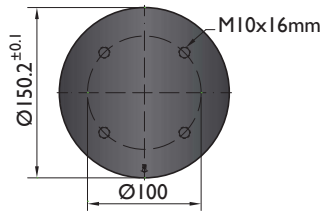
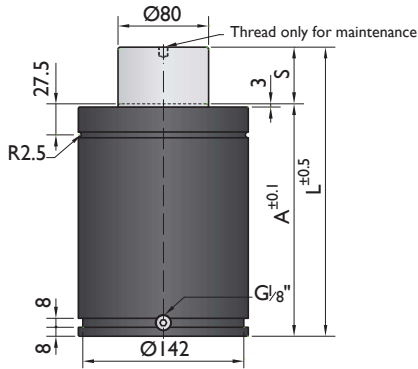

Ordering example: 4 x SG-7500-125

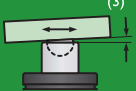
Order No.	S ⁽¹⁾ mm	L mm	A mm	F ₀ ⁽²⁾ daN (20°C, 150 bar)	F daN	 ⁽³⁾	kg
SG-7500-25	25	205	180		9000	No	18.06
SG-7500-38	38.1	231.2	193.1		9400	No	18.93
SG-7500-50	50	255	205		9700	No	20.30
SG-7500-63	63.5	282	218.5		9900	No	21.08
SG-7500-80	80	315	235		10100	No	22.21
SG-7500-100	100	355	255	7500	10500	Yes	23.47
SG-7500-125	125	405	280		10700	Yes	24.96
SG-7500-160	160	475	315		10900	Yes	27.01
SG-7500-200	200	555	355		11100	Yes	29.81
SG-7500-250	250	655	405		11200	Yes	33.01
SG-7500-300	300	755	455		11300	Yes	36.11

⁽¹⁾ other strokes under request

⁽²⁾ alternative forces upon request

⁽³⁾ ESK available for other strokes

* other strokes under request

* alternative forces upon request



Pressure medium N₂
Max. Charging pressure 150 bar
Min. Charging pressure 25 bar

Working temperature 0-80°C
Temperature related force increase +0.34%/°C
Max. working speed 2 m/s

Min. security stroke 10%
Repair Kit KIT CN-7500
Linkable M6-G1/8"

Mounting possibilities

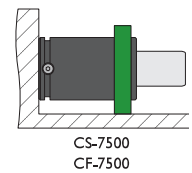
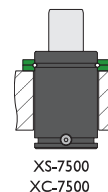
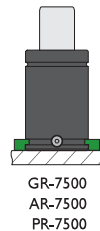
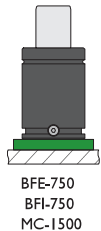
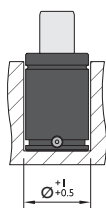
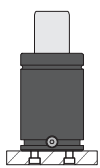

Flange must not support spring's force

Flanges

BFE-7500

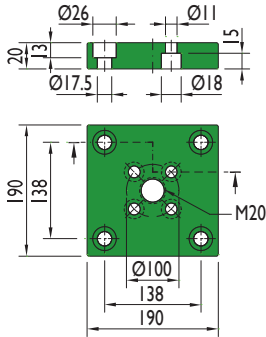

BFI-7500

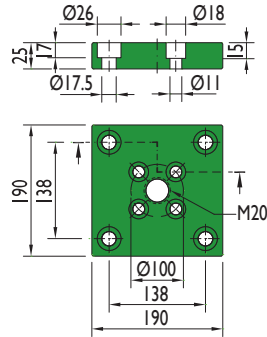

GR-7500

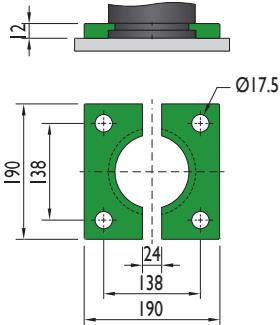

AR-7500

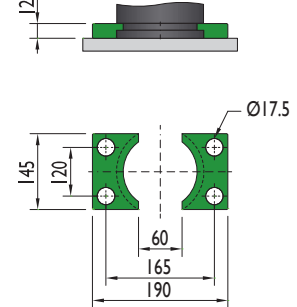

XS-7500

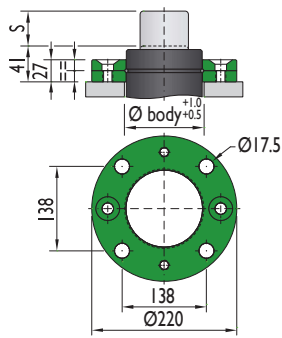

XC-7500

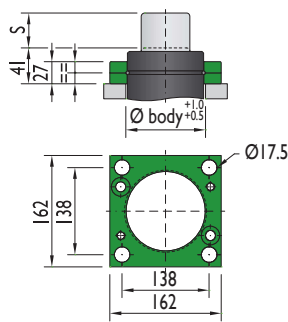

PR-7500

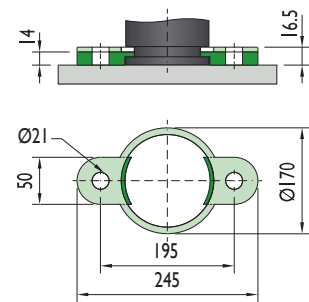

CS-7500

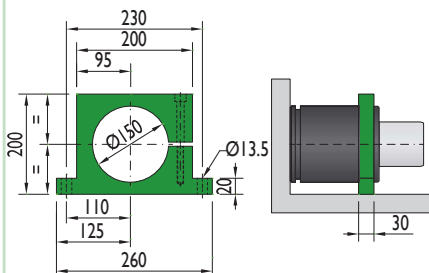

Flange must not support spring's force



CF-7500

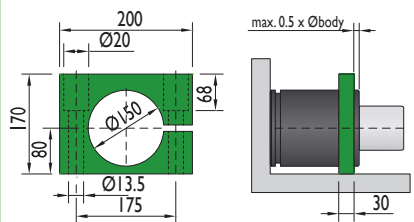

Flange must not support spring's force



Contacts



CAD files of the product can be downloaded FREE from our website:
<http://www.nitrogas.com/es/Downloads.aspx>



Commercial

 comercial@nitrogas.com



Training

 training@nitrogas.com



Engineering

 engineering@nitrogas.com



Maintenance

 maintenance@nitrogas.com



Contact hours

NITROGAS offers 24 hs contact service.

NITROGAS



nitrogas@nitrogas.com
www.nitrogas.com

NITROGAS